

# VINYL APPLICATION INSTRUCTIONS

## YOU WILL NEED:

Rubbing Alcohol or Soap & Water, Paper Towels, Masking/Painters Tape, Credit/Store Card.

**BE SURE TEMPERATURE IS AT LEAST 55 DEGREES  
DO NOT APPLY IN DIRECT SUNLIGHT**

### METHOD ONE: HINGE METHOD

*Preferred by professionals to ensure placement is where you want it and to reduce the likelihood of wrinkles/bubbles.*

**STEP 1:** Clean the area thoroughly with rubbing alcohol or soap and water. **Do not use Windex** or similar products as they will leave a residue behind that prevents the vinyl from adhering correctly.

**STEP 2:** With the backing still on the vinyl, use masking tape or painters tape (low adhesive) to align the sticker where you want it to be applied.

**STEP 3:** Slowly peel the backing off. Make sure the vinyl is sticking to the clear transfer tape (already applied). Only peel halfway, and cut the backing off at the midpoint.

**STEP 4:** Use a credit/store card to firmly press the vinyl to the surface. Start in the middle where you cut the backing off. Hold the outer sticky edge away from the surface, and slowly move the card across the vinyl working your way from middle to edges. Once you have one side stuck down, peel away the other half of the backing and do the same for that side.

**STEP 5:** Slowly peel away the clear transfer tape. Be sure none of the vinyl comes up with the transfer tape. If it does, use the card to re-apply to the surface.

**STEP 6:** Smooth out any bubbles with the card starting from the center and working them out to the edges. Small bubbles will work themselves out after a day or two.

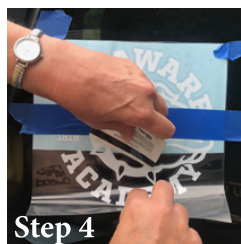

### METHOD TWO

**STEP 1:** Clean the area thoroughly with rubbing alcohol or soap and water. **Do not use Windex** or similar products as they will leave a residue behind that prevents the vinyl from adhering correctly.

**STEP 2:** Slowly peel the backing off completely. Make sure the vinyl is sticking to the clear transfer tape (already applied). Lightly tack the decal with transfer tape by one corner in the position you would like to apply the decal.

**STEP 4:** Use a credit/store card to firmly press the vinyl to the surface, working your way from middle to edges.

**STEP 5:** Slowly peel away the clear transfer tape. Be sure none of the vinyl comes up with the transfer tape. If it does, use the card to re-apply to the surface.

**STEP 6:** Smooth out any bubbles with the card starting from the center and working them out to the edges. Small bubbles will work themselves out after a day or two.